

Installation Manual

AS-2762
ARNOTT
REAR AIR STRUT
LAND ROVER LR3/DISCOVERY III
LAND ROVER LR4/DISCOVERY IV
LAND ROVER RANGE ROVER SPORT W/VDS

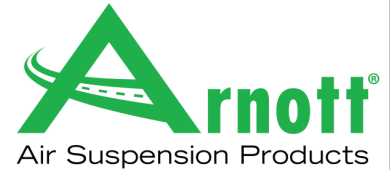

Congratulations on your purchase of an Arnott® air suspension product. We at Arnott Incorporated are proud to offer a high quality product at the industry's most competitive pricing. Thank you for your confidence in us and our product.

Proper installation is essential to experience and appreciate the benefits of this system. Please take a moment to review these installation instructions before you begin to install these components on your vehicle. The removal and installation of air suspension products should only be performed by a fully qualified, ASE Certified, professional.

It is equally important to be aware of all necessary safety measures while installing your new Air Suspension System. This includes proper lifting and immobilizing of the vehicle and isolation of any stored energy to prevent personal injury or property damage.

"Engineered to Ride, Built to Last®"



WARNING: *The air suspension system is under pressure (up to 10 bar, or 150 lbf/in). Verify pressure has been relieved and disconnect power to the air suspension system prior to disassembly. Do not allow dirt or grease to enter the system. Always wear standard hand, ear, and eye protection when servicing the air suspension system.*

Arnott® is committed to the quality of its products. If you have a question or problem with any Arnott product, please contact Arnott by calling **800-251-8993** during normal business hours or email techassistance@arnottinc.com. (In the EU please call +31 (0)73 7850 580 or email info@arnotteurope.com)

GENERAL INFORMATION:

Reading this manual signifies your agreement to the terms of the general release, waiver of liability, and hold harmless agreement, the full text of which is available at www.arnottinc.com.

- Not to be stored below 5°F (-15°C) or above 122°F (50°C).
- Avoid damage to air lines and cables.
- Removal and installation is only to be performed by fully qualified personnel.
- Use car manufacturer's diagnostic software.

CAUTION: Damage to the vehicle and air suspension system can be incurred if work is carried out in a manner other than specified in the instructions or in a different sequence.



To avoid the possibility of short circuits while working with electric components consult your owner's manual on how to disconnect your battery.



Consult your vehicle owner's manual, service manual, or car dealer for the correct jacking points on your vehicle and for additional care, safety and maintenance instructions. Under no circumstances should any work be completed underneath the vehicle if it is not adequately supported, as serious injuries and death can occur.

FRONT AIR STRUT REMOVAL

1. REMOVE REAR WHEEL TO EXPOSE THE REAR AIR STRUT. (FIGURE 1)



FIGURE 1

2. LOOSEN AND REMOVE THE LOWER MOUNT NUT. SUPPORT THE AIR STRUT AND REMOVE THE LOWER MOUNT BOLT. (FIGURES 2, 3)



FIGURE 2



FIGURE 3

3. LOOSEN AND REMOVE THE THREE (3) TOP MOUNTING NUTS. (FIGURE 4)



FIGURE 4

4. UNPLUG THE AIR STRUT'S ELECTRICAL CONNECTOR. (FIGURE 5)



FIGURE 5

5. CAREFULLY LOWER THE AIR STRUT TO GAIN ACCESS TO THE AIR LINE. UNTHREAD THE AIR FITTING. (FIGURE 6)



FIGURE 6

6. REMOVE THE AIR STRUT FROM THE VEHICLE. (FIGURE 7)



FIGURE 7

7. REMOVE THE AIR LINE FITTING FROM THE AIR HOSE AND DISCARD. TO REMOVE THE AIR LINE FITTING, REMOVE THE COLLET AND THE REMAINING FITTING WILL SLIDE OFF OF AIR HOSE. (FIGURE 8)

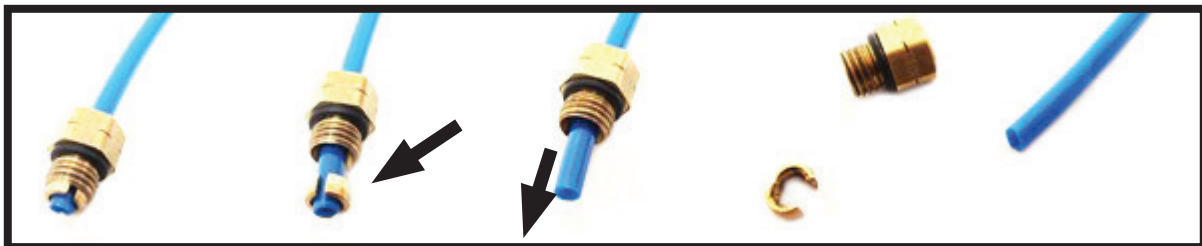

FIGURE 8

8. REMOVAL COMPLETE.

FRONT AIR STRUT INSTALLATION



Tighten all nuts and bolts to manufacturer's specifications during the installation process.

1. PLACE NEW AIR STRUT ONTO VEHICLE, ORIENTED IN THE SAME POSITION AS STRUT PREVIOUSLY REMOVED. (FIGURE 9)



FIGURE 9

2. INSERT THE AIR LINE INTO THE VOSS FITTING, MAKING SURE IT IS FIRMLY SEATED AND WILL NOT PULL BACK OUT. (FIGURE 10)

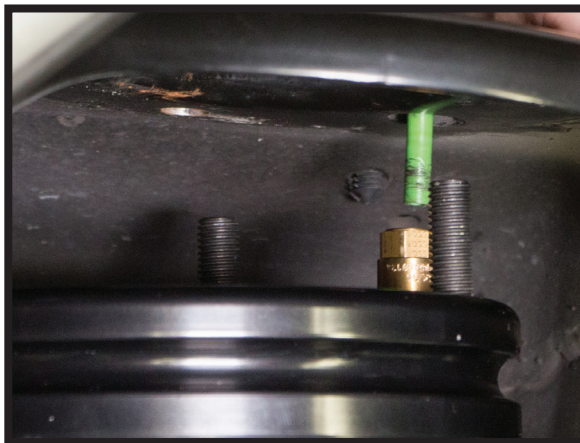

FIGURE 10

3. CONNECT THE ELECTRICAL CONNECTOR. (FIGURES 11, 12)



FIGURE 11



FIGURE 12

4. INSTALL AND TIGHTEN THE THREE (3) TOP MOUNTING NUTS TO MANUFACTURER'S SPECIFICATION. (FIGURE 13)



FIGURE 13

5. SUPPORT THE AIR STRUT AND INSTALL THE LOWER MOUNT BOLT. RE-INSTALL AND TIGHTEN THE LOWER MOUNT NUT TO MANUFACTURER'S SPECIFICATION. (FIGURES 14, 15)



FIGURE 14



FIGURE 15

6. RE-INSTALL THE REAR WHEEL AND TIGHTEN LUG NUTS TO MANUFACTURER'S SPECIFICATION.
(FIGURE 16)



FIGURE 16

7. INSTALLATION COMPLETE.